

\$9,500,000 - 84081 Rge Rd 191, Rural Lethbridge County

MLS® #A2261739

\$9,500,000

0 Bedroom, 0.00 Bathroom,
Agri-Business on 318.60 Acres

NONE, Rural Lethbridge County, Alberta

318.6 acres of farmland with 277 acres of water rights, SE of Coaldale, Alberta.

NW 25-08-19-W4 - Includes 157 acres and 125 acres of water. 52,000 bushel grain storage. 3 Bay shop 40 x 80. 2013 Zimmatic 8500 pivot. Seperate titled 1640 sqft, 3 bedroom bungalow with double garage. NE 25 - 08-19-W4 - Includes 160 acres and 152 acres of water. 1984 Reinke with corner arm Pivot.

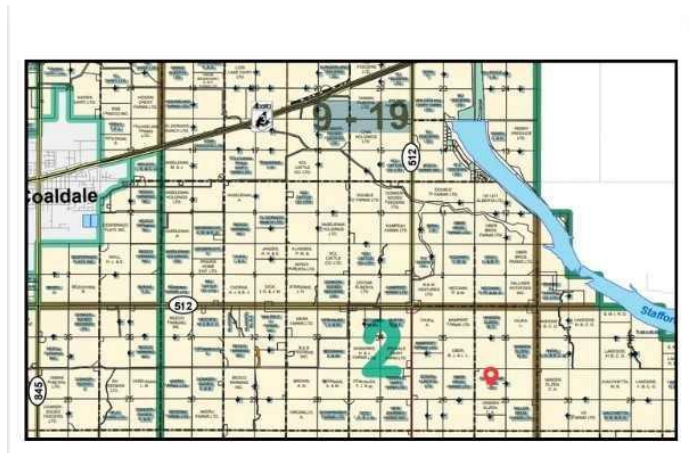

Essential Information

MLS® #	A2261739
Price	\$9,500,000
Bathrooms	0.00
Acres	318.60
Type	Agri-Business
Sub-Type	Agriculture
Status	Active

Community Information

Address	84081 Rge Rd 191
Subdivision	NONE
City	Rural Lethbridge County
County	Lethbridge County
Province	Alberta
Postal Code	T1M 1M3

Amenities

Utilities Electricity Connected, Natural Gas Connected

Additional Information

Date Listed October 2nd, 2025

Zoning Ag

Listing Details

Listing Office Bankers Commercial Real Estate

Data is supplied by Pillar 9â„¢ MLS® System. Pillar 9â„¢ is the owner of the copyright in its MLS® System. Data is deemed reliable but is not guaranteed accurate by Pillar 9â„¢. The trademarks MLS®, Multiple Listing Service® and the associated logos are owned by The Canadian Real Estate Association (CREA) and identify the quality of services provided by real estate professionals who are members of CREA. Used under license.