

\$110,000 - Lot 2, Willowside Estates, Rural Woodlands County

MLS® #A2261275

\$110,000

0 Bedroom, 0.00 Bathroom,
Land on 13.07 Acres

NONE, Rural Woodlands County, Alberta

Own land! Get out of town and take in the peace of Willowside Estates, Woodlands County. 13.07 Acres of Countryside Blissâ€”Perfect to Call Home for you and possibly pets. Lot 2 is rolling landscapes, a short drive to Whitecourt or Mayerthorpe. This land features room for your garden or hobby farm. There are no deadlines for construction, allowing you to enjoy this space as your private camp or retreat. The area is surrounded by farmland, wildlife, and nature, providing a tranquil atmosphere. Utilities such as power and gas are available in the subdivision; you also have the option to go off-grid. Property taxes are \$620 per year. There is a short county road of gravel coming off of the paved 751.

Essential Information

MLS® #	A2261275
Price	\$110,000
Bathrooms	0.00
Acres	13.07
Type	Land
Sub-Type	Residential Land
Status	Active

Community Information

Address Lot 2, Willowside Estates

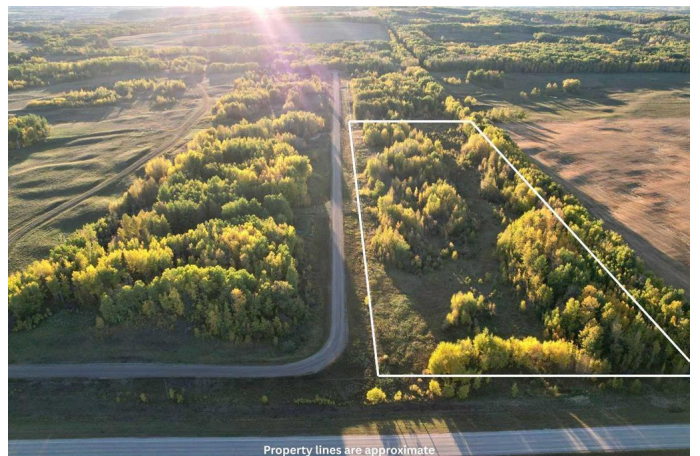

Subdivision	NONE
City	Rural Woodlands County
County	Woodlands County
Province	Alberta
Postal Code	T0E 1N0

Additional Information

Date Listed	October 1st, 2025
Zoning	Agricultural

Listing Details

Listing Office	ROYAL LEPAGE MODERN REALTY
----------------	----------------------------

Data is supplied by Pillar 9â„¢ MLS® System. Pillar 9â„¢ is the owner of the copyright in its MLS® System. Data is deemed reliable but is not guaranteed accurate by Pillar 9â„¢. The trademarks MLS®, Multiple Listing Service® and the associated logos are owned by The Canadian Real Estate Association (CREA) and identify the quality of services provided by real estate professionals who are members of CREA. Used under license.